



FIELD INSTALLATION INSTRUCTION FOR HINGED PATIO ENTRY DOOR SCREEN ASSEMBLY

IMPORTANT INFORMATION BEFORE YOU BEGIN

This document is to assist with the field installation instruction for a new hinged patio screen assembly ordered as:

- **REPLACEMENT OF AN EXISTING HINGED PATIO SCREEN ASSEMBLY**

OR

- **SCREEN SYSTEM SHIPPED LOOSE WITH NEW ENTRY DOOR HINGED PATIO UNIT**

* Jamb depth will determine the installation location. Refer to illustrations on following page.

SCREEN INSTALLATION CONTENTS (FOUND IN HARDWARE BOX):

· Screen Door	· (1) Screen Keeper
· Bottom Screen Guide (Rail) (Factory cut to length)	· (1) RH Roller (Wheel) Bracket Assembly
· Screen Top Track Assembly with (3) Adjustment Screws, Inner and Outer Cover (Factory cut to length)	· (1) LH Roller (Wheel) Bracket Assembly
· (3) Common Screen Black Bumpers	· (2) #6-32 x 7/8" Phillips Flat Head Zinc Screws (For wheel brackets)
· (3) #6 x 5/8" Phillips Pan Head Self Tapping Screws (Common Screen Black Bumpers)	· (2 to 4) #8 x 1/2" Pan Head Self Tapping Tek Screws (For Keeper & 3-Lite Black Bumpers)
· Strike Side Screen Stop Strip (Factory cut to length)	· (7) #8 x 3/4" Phillips Pan Head Zinc Screws (Install screws) (3 for Screen Top Track, 4 for Stop Strip)

SCREEN ASSEMBLY PART REFERENCE

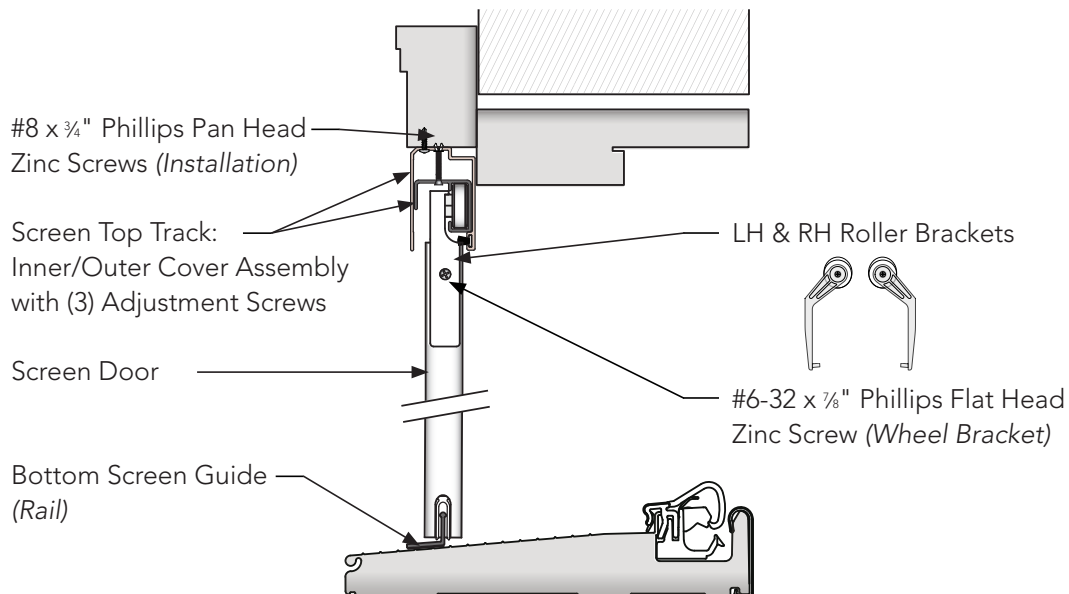

Read these instructions carefully before starting installation. Product warranty does not cover damages resulting from improper installation.

DETERMINING INSTALL LOCATION FOR NEW SCREEN

THE PATIO UNIT'S JAMB DEPTH WILL DETERMINE WHERE THE PATIO SCREEN WILL BE INSTALLED.
REFER TO ILLUSTRATIONS BELOW TO DETERMINE LOCATION.

STANDARD 4 $\frac{5}{16}$ " JAMB DEPTH →

Top hung screen is mounted inside
brickmold

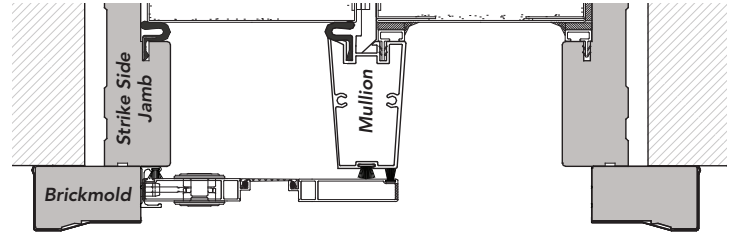

4 $\frac{5}{16}$ " TO 6 $\frac{1}{2}$ " JAMB DEPTH →

Top hung screen is mounted inside
brickmold

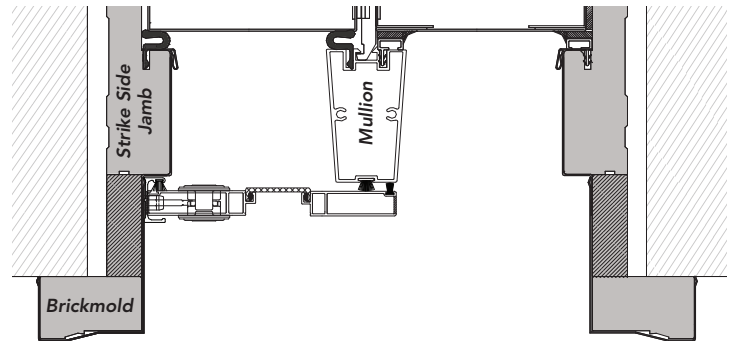

6 $\frac{5}{16}$ " AND WIDER JAMB DEPTH →

Top hung screen is mounted inside
jamb extension

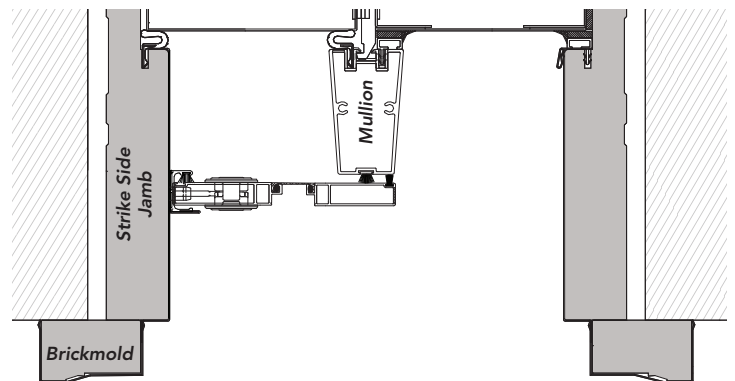

3-LITE HINGED PATIO DOOR →

Follow the same jamb depth principles as
listed above

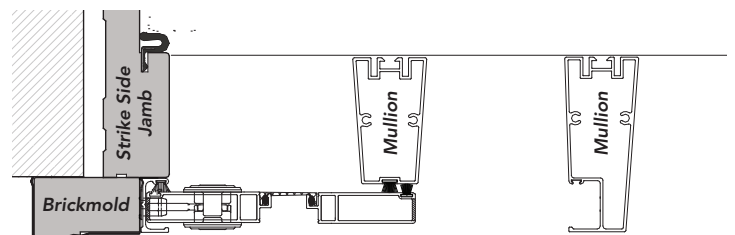

A. REMOVE SCREEN (FOR REPLACEMENT)

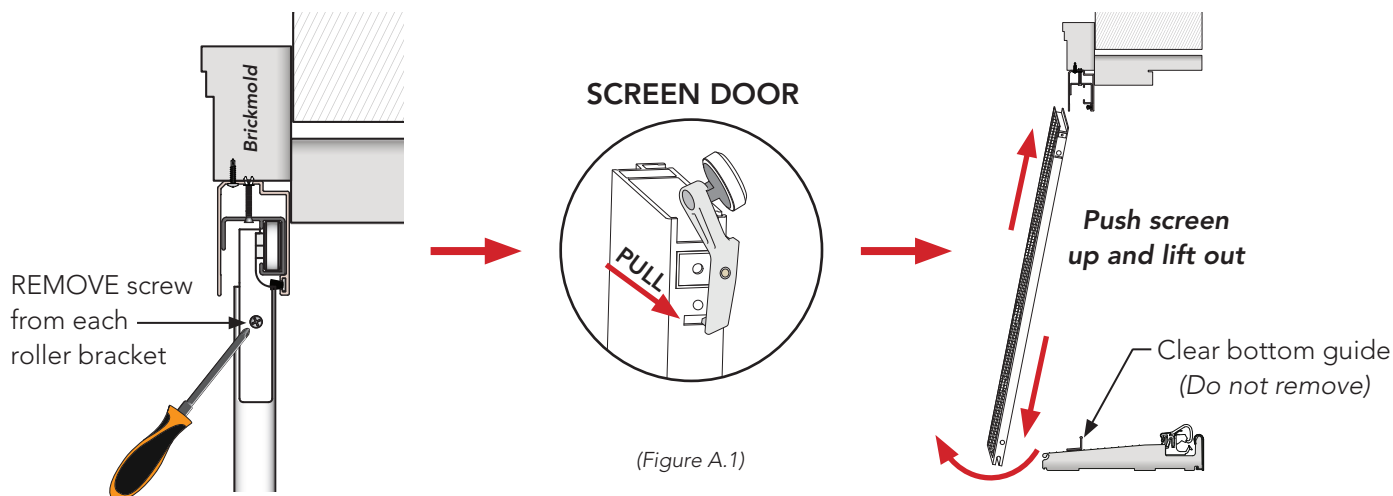

- 1 Use a Phillips head screwdriver to remove the screw from RH and LH roller brackets. (Figure A.1)
- 2 Remove roller brackets from screen door. Pull bracket outward from screen bottom guide groove. For **screen door ONLY replacement**; if brackets are undamaged, roller brackets can remain in screen cover track for ease of new screen door installation. If brackets are damaged or for a full screen assembly replacement, remove from track at this time. (Figure A.1)
- 3 Remove screen door. Lift screen upward so bottom clears the screen bottom guide (rail). (Figure A.1)

B. REMOVE COVER ASSEMBLY (FOR REPLACEMENT)

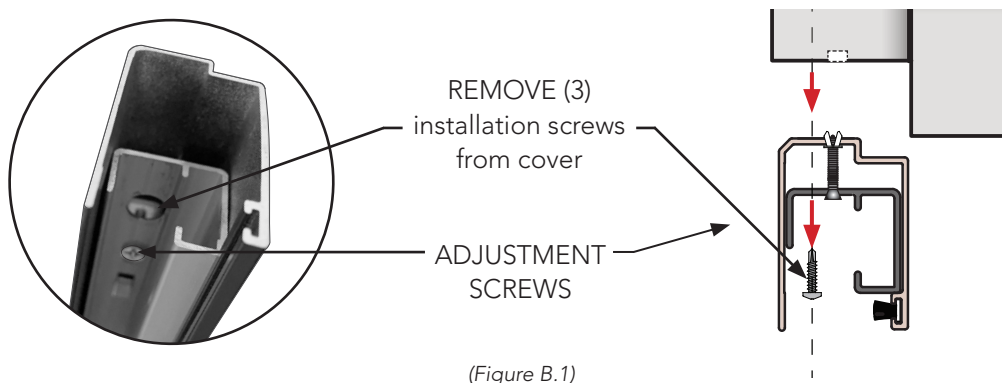

- 1 **ONLY if needed**, the top screen cover assembly can be uninstalled by removing the (3) #6 x 1¼" Phillips pan head screws located inside the outer screen cover (refer to Figure above). The (3) adjustments screws do not need removed. Note, the number of installation screws will depend on door size. (Figure B.1)

C. INSTALL SCREEN COVER AND WHEEL BRACKETS

NEW HINGED PATIO UNIT:

New unit MUST BE fully installed with brickmold cladding attached and sealed per main installation instruction. Reminder: It is CRITICAL to leave a $\frac{7}{16}$ " reveal when installing the brickmold (per main instruction).

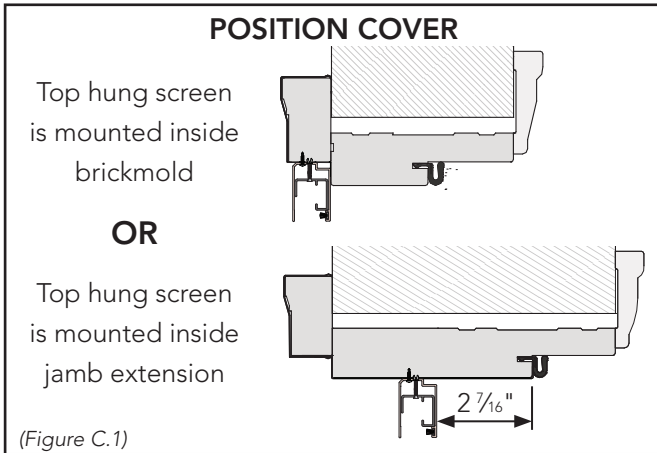

⚠ IMPORTANT! DO NOT REMOVE pre-assembled ADJUSTMENT SCREWS from screen cover assembly AT ANY TIME.

- 1 Position cover assembly in the header opening.
 - a. If cover is to be applied within brickmold opening, place tight against jamb. (Figure C.1)
 - OR
 - b. If cover is to be applied within the jamb, place against the mull post (measuring $2\frac{7}{16}$ " from the edge of rabbet). (Figure C.1)

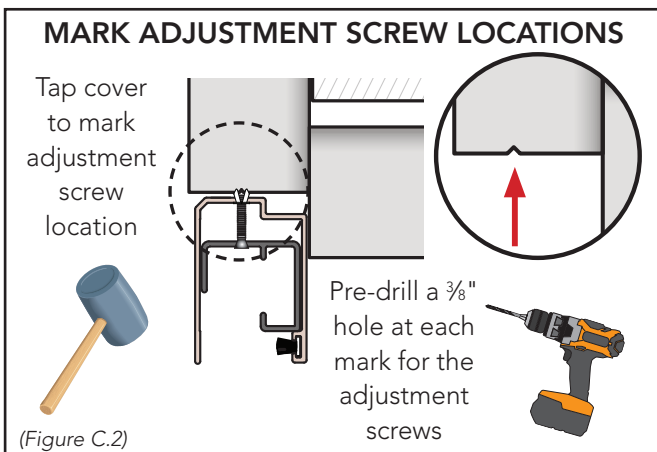

- 2 Use the factory pre-drilled installation holes located in the cover to mark install screw locations.
- 3 Tap on the cover using a rubber mallet to mark the location of the adjustment screws. Then pre-drill a $\frac{3}{8}$ " hole in brickmold header to allow room for the adjustment screws tips. (Figure C.2)

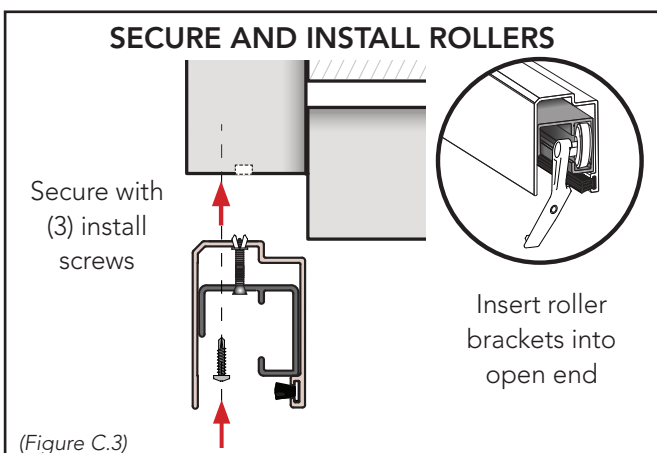

- 4 Re-position the cover in the opening and secure with (3) #8 x $\frac{3}{4}$ " installation screws (included) through the inner and outer track. Be sure when securing the cover that it does **NOT** roll. Cover MUST sit PARALLEL to brickmold header. (Figure C.3)
- 5 For new units, insert the LEFT and RIGHT screen roller brackets into an open end of the cover assembly's inner track. Brackets are labeled and identified from outside looking in. BE SURE each wheel bracket is positioned correctly. Refer to the QR code located at the end of this instruction for a helpful video. (Figure C.3)

D. INSTALL STRIKE-SIDE SCREEN STOP RAIL

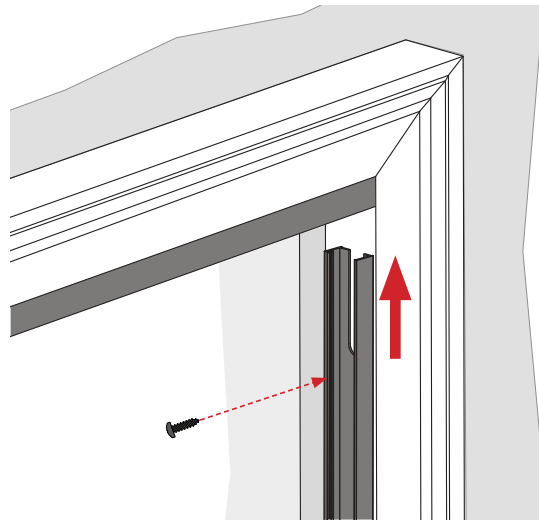

Locate top of rail flush with bottom of screen cover assembly, secure the (4) screws

(Figure D.1)

- 1 Place the strike-side stop rail against the brickmold cladding with elongated notch located at the top. Position stop rail with top seated flush against the bottom side of the cover assembly. Secure using (4) #8 x $\frac{3}{4}$ " Phillips pan head screws (included) through the factory pre-drilled installation holes. (Figure D.1)

NOTE: A 3-Lite Center Active door configuration will NOT receive a strike-side stop rail.

E. INSTALL BOTTOM SCREEN GUIDE



Score line

Start screen guide just inside strike-side rail, use threshold lines to lay guide straight and parallel

(Figure E.1)

- 1 Clean threshold with alcohol.
- 2 Remove paper backing from bottom screen guide.
- 3 Position with flat horizontal leg to the outside. Start end of the guide just inside the stop rail with the vertical leg aligned with the rail's center score line (for 3-lite unit without a stop rail, center on the mull post score line). Center length between brickmold with approximately $\frac{1}{4}$ " gap each side. Use the threshold lines to lay guide straight and parallel. Press to adhere in place. (Figure E.1)

F. INSTALL SCREEN, BUMPERS, AND KEEPER

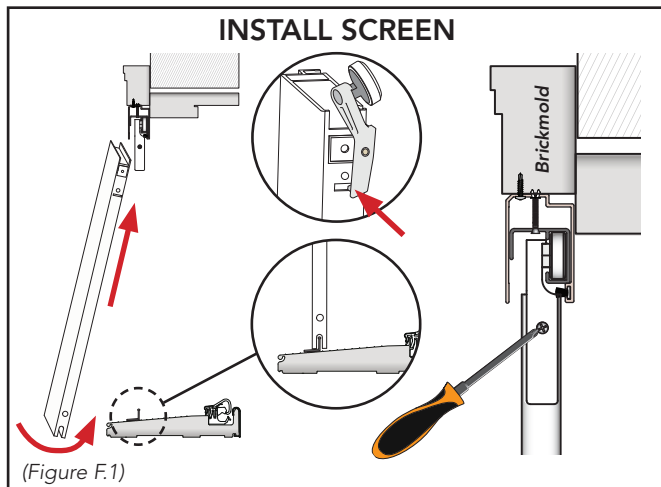

- 1 Lift screen into top screen track assembly and between roller brackets. (Figure F.1)
- 2 Lift up and position bottom of screen onto the screen bottom guide (rail). (Figure F.1)
- 3 Insert Left and Right roller bracket tabs into grooves located at top of screen frame. (Figure F.1)
- 4 Secure each roller bracket using a Phillips head screwdriver to install a #6-32 x 7/8" Phillips flat head screw (included). **DO NOT** use excessive torque on bracket screws. (Figure F.1)

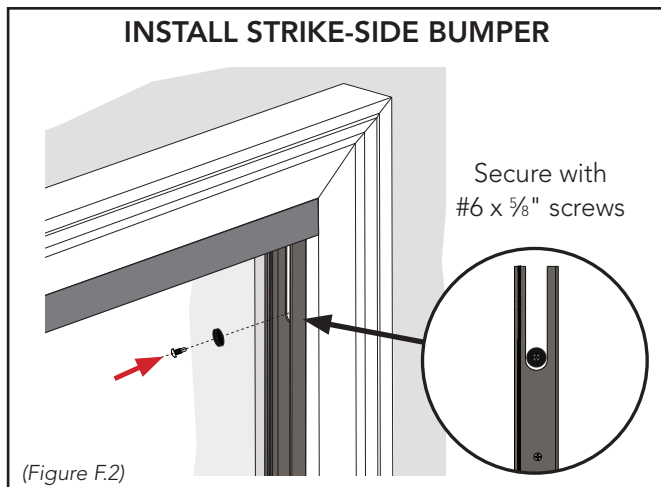

- 5 Install (1) bumper with a #6 x 5/8" self-tapping screw (included) in the bottom of the strike-side stop rail notch. (Figure F.2)

NOTE: For a **3-Lite Center Active**, install bumper on mull post approximately 6" from top using a #6 x 1/2" self-tapping screw.

- 6 Install (2) bumpers on the inactive jamb-side with the #6 x 5/8" screws located approximately 6" from the top and bottom. *Tip: Lightly mark the edge of the screen against the jamb. Use the mark to locate the edge of each bumper for proper in/out placement.*

NOTE: For a **3-Lite Side Active**, install (2) bumpers on the mull post with #6 x 1/2" screws located approximately 6" from the top and bottom.

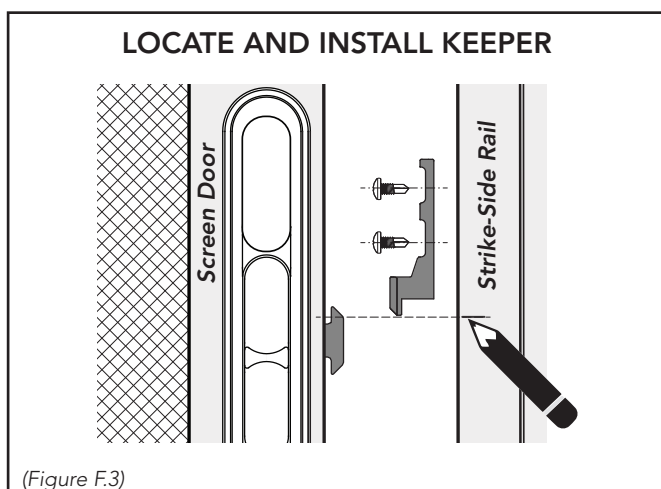

- 7 Install or re-install the keeper. For a new install, close screen leaving a small gap. Lightly mark a line on the strike-side rail even with the top front face of the screen latch. Locate keeper by aligning the bottom edge with pencil mark. Secure with (2) #8 x 1/2" pan head self-tapping screws. (Figure F.3)

G. SCREEN AND KEEPER ADJUSTMENT

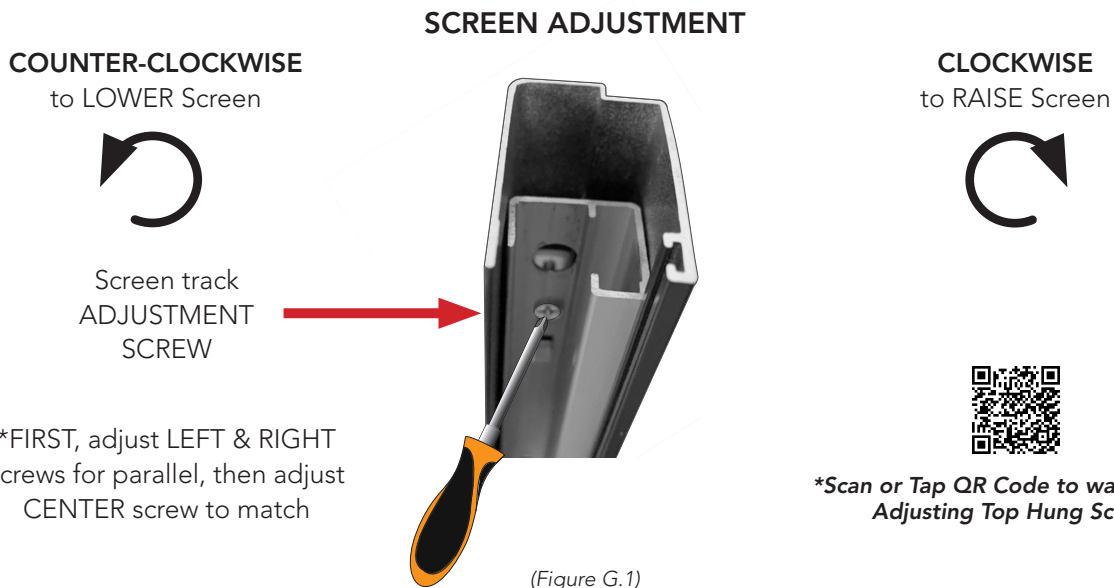

- 1 To adjust height and square of screen, turn the **Left** and **Right** adjustment screws until screen is parallel with the sash and jamb. Once screen placement is established, adjust the **Center** screw to match. (Figure G.1)

NOTE: Each complete turn of adjustment screws will raise or lower track by $\frac{1}{32}$ ". Turn counter-clockwise to **LOWER** the screen and clockwise to **RAISE** the screen. **DO NOT REMOVE** the adjustment screws. (Figure G.1)

NOTE: DO NOT USE a power drill for adjustments. Doing so will cause excessive torque on the screws. **ONLY** use a #2 Phillips head screwdriver.

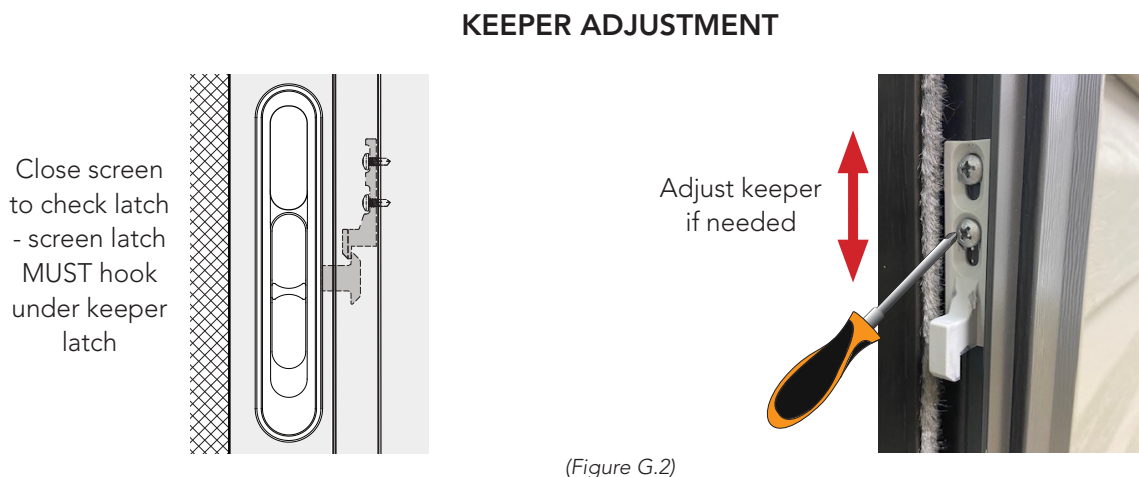

- 2 After screen height and alignment is established, close screen to check for proper latch. If the screen is not latching properly, check screen latch for proper operation. Screen latch should hook underneath keeper. Latch should always release when pushing down on latch slide. If adjustments are required, use a #2 Phillips head screwdriver to loosen keeper screws and move keeper up or down as needed. (Figure G.2)

FOR ADDITIONAL INFORMATION AND HELPFUL VIDEOS, SCAN OR TAP ON THE QR CODES:

HOMEPAGE FOR INSTALLERS
(Access to all our instructions
and how-to videos)



VIDEO: Adjusting Top
Hung Screen

