

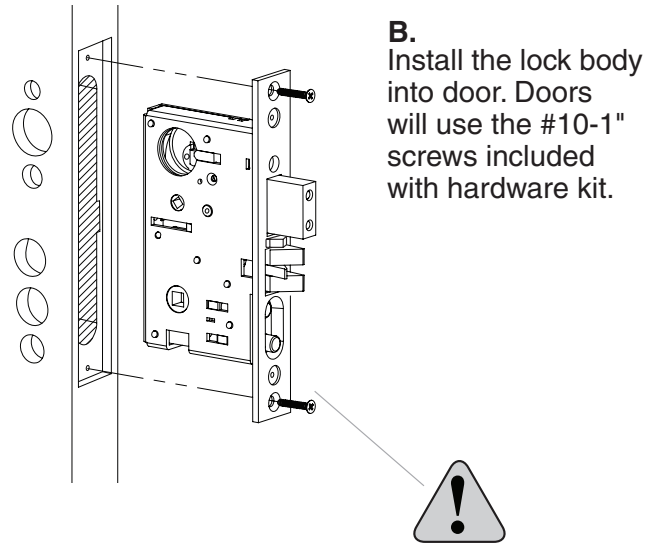

EMTEK MORTISE HANDLE INSTALLATION

Tools & Materials Needed:	Handle Kit Contents:	
• Cordless Drill	(1) Emtek Mortise Inside & Outside Handle	(1) Strike Plates & Dust Box with #10 x 3" Screws
• Screw Driver	(1) Bag containing Installation Screws	(1) Package of 4 - #10 x 2½" Screws used for Door Hinges.

1 Remove Shipping Support Bracket & Install Backset

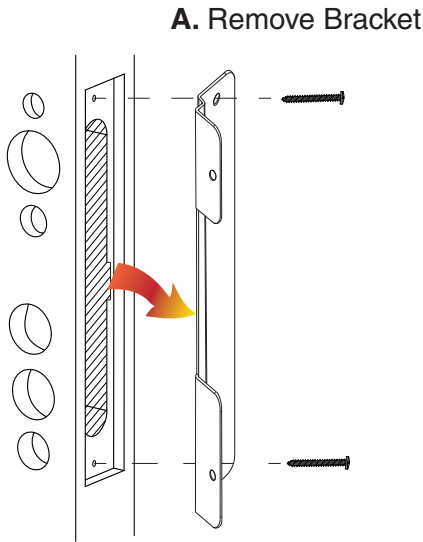

2 Install Exterior Handle

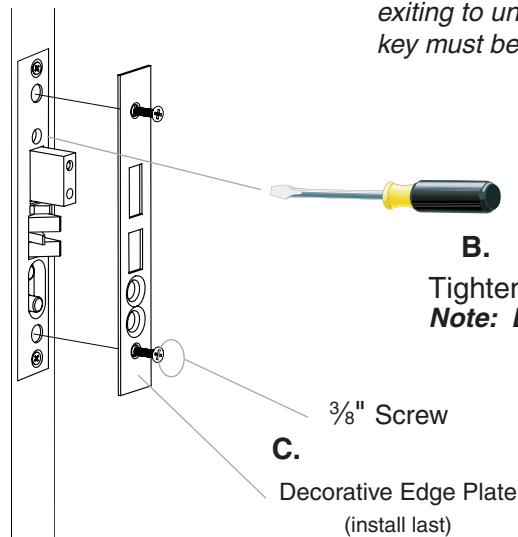
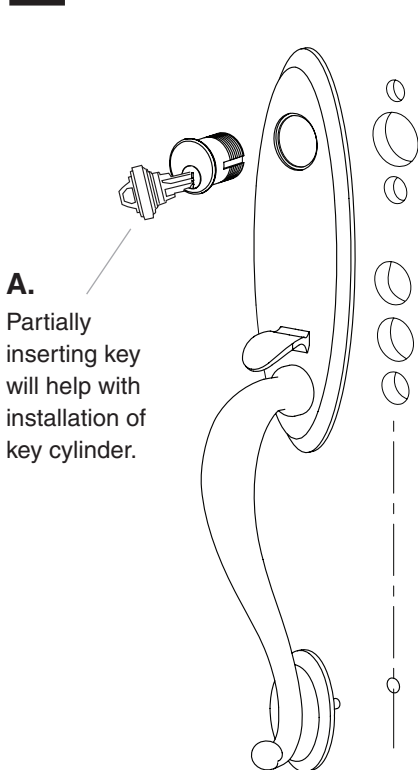

Important Information for Homeowner:
Top Button will retract when deadbolt is thrown and will keep exterior handle locked at all times.
Bottom Button must be pushed in before exiting to unlock exterior handle. Otherwise, a key must be used to unlock exterior handle.

Plates and grip will vary depending on style.

3

Install Interior Handle

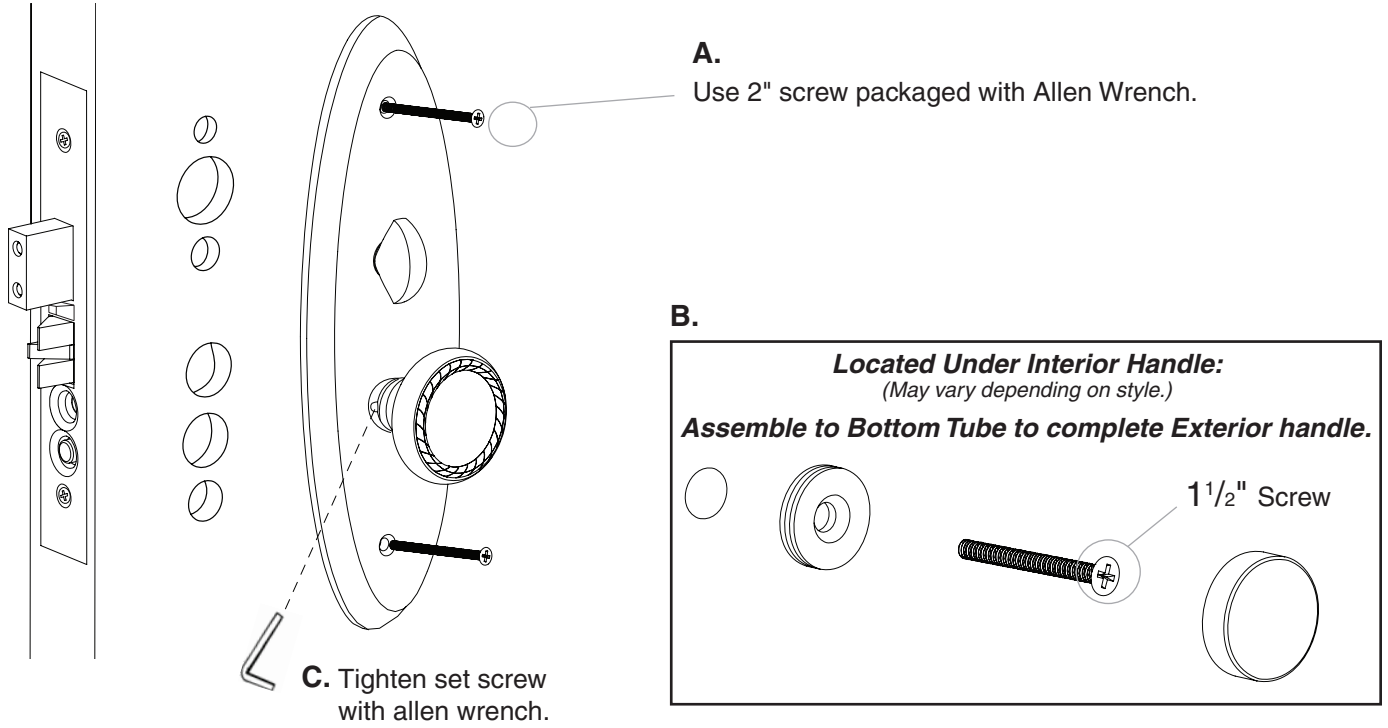

4

Install Strike Plate into Door Jamb

