

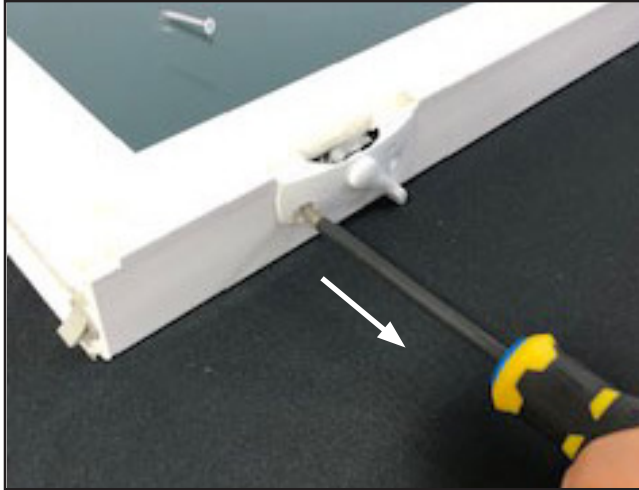

# REPLACEMENT INSTRUCTIONS

## DUALTECH™ LOCK FOR VINYL WINDOWS



1

Completely remove bottom sash from window unit. Place bottom sash on a flat surface with exterior side facing up.

2

Using a screwdriver, remove the (2) screws from each existing lock. To release cam arm, rotate the lock clockwise for LH side or counterclockwise for the RH side.

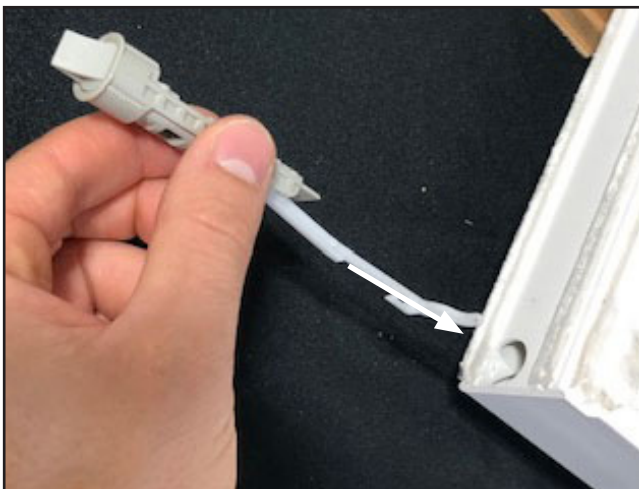

4

Install new replacement latch assembly by sliding into the latch pocket. Be sure latch assembly is flush with window stile.

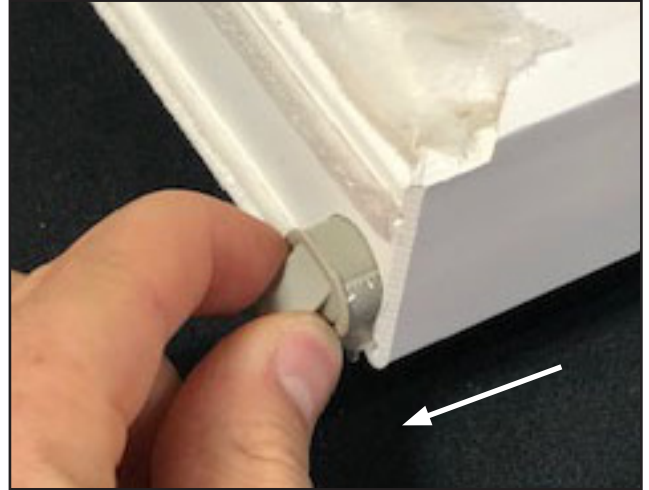

3

Grasp the end of the latch assembly and pull to remove. Repeat on opposite side.



5

With the lock in the unlocked position, place the cam arm in the corresponding hole of the latch assembly.



# REPLACEMENT INSTRUCTIONS DUALTECH™ LOCK FOR VINYL WINDOWS



6

Gently push down on cam arm until the clasp is fully seated.



7

Rotate lock to fully engage. Rotate the lock in a counter-clockwise direction for LH side or clockwise for the RH side.



8

Test function of lock to ensure the full assembly is operating properly.



9

With DualTech™ assembly in full operation, secure each lock with the (2) color-matched screws.