

INSTALLATION INSTRUCTIONS FOR STEEL FRAME ONTO WOOD STUD WALL

Tools & Materials You Will Need:

• 1" Thick Wood Spreader	• Long Carpenter's Level
• Flathead Screwdriver	• Carpenter's Square
• Shims	• Hammer
• Wood Studs for Framing	• (1) Box Drywall Screws
• (1) Box Self Tapping Screws	



IMPORTANT! If a threshold is to be installed, **DO NOT install until AFTER the steel frame is fully assembled and secured in opening.**



JOB SITE STORAGE: Store frame off the ground on wood runners or skids. **DO NOT STORE** directly on the ground. Cover frames with tarpaulin or plastic, ensuring that adequate ventilation is provided to eliminate moisture condensation.

When frames are fully grouted and/or when plaster or mortar contain "anti-freeze" agents, the inside of the frames should be coated with a bituminous, water-resistant paint by the installation contractor.

REMEMBER: ALWAYS USE THE APPROPRIATE PERSONAL PROTECTIVE EQUIPMENT.



Homes built before 1978 may contain lead paint. All replacement installations must comply with the U.S. EPA's Lead-Based Paint Renovation, Repair, and Painting Program (RRP Rule). Read more about the RRP Rule and lead-safe work practices, on the U.S. EPA's website at: www.epa.gov/lead

1

PREPARE ROUGH OPENING

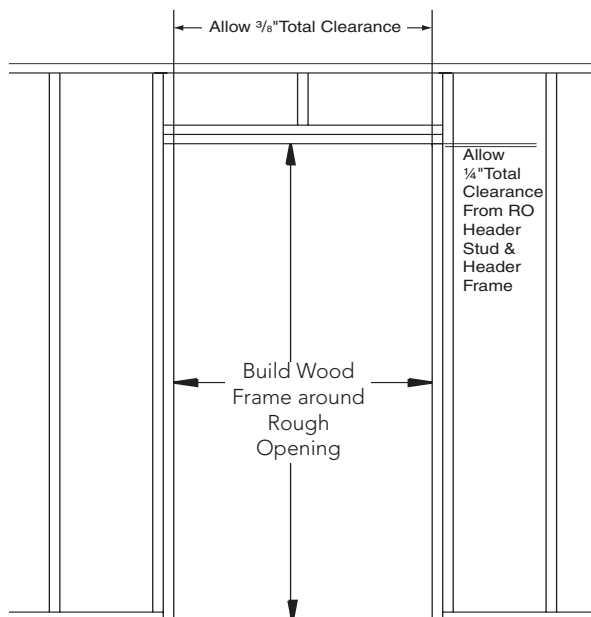

It is recommended double studs be used at the jambs and header.

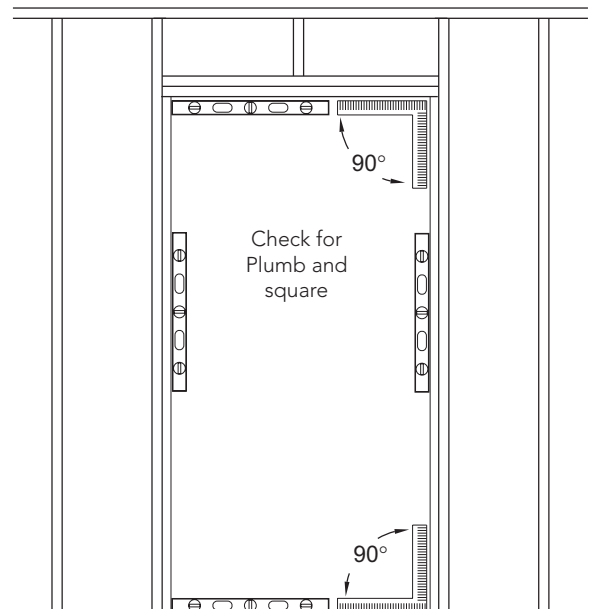

Step 1-

Build a wood frame around the rough opening allowing $\frac{3}{8}$ " total clearance between upright studs and frame sides ($\frac{3}{16}$ " clearance per side and $\frac{1}{4}$ " clearance between frame header and rough opening header stud).

Step 2-

Check frame opening for plumb and square.

2 ATTACH FRAME ANCHORS

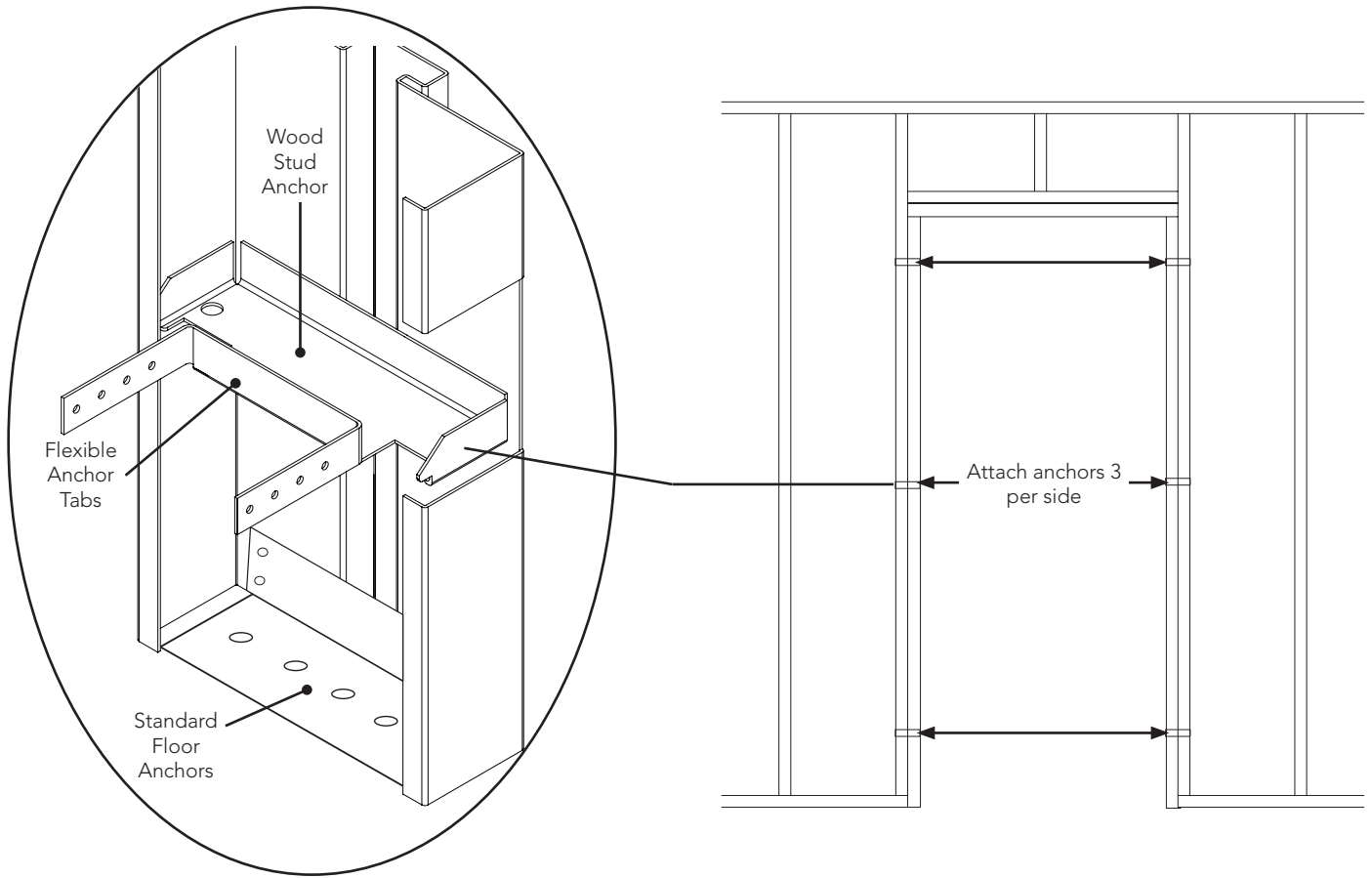

Step 1-

Insert wood stud anchors into frame throat and tap into place with a hammer.

Step 2-

Place at hinge location and directly opposite on strike frame. Attach 3 anchors per side, totalling 6 per frame.

3 INSTALL FRAME INTO OPENING

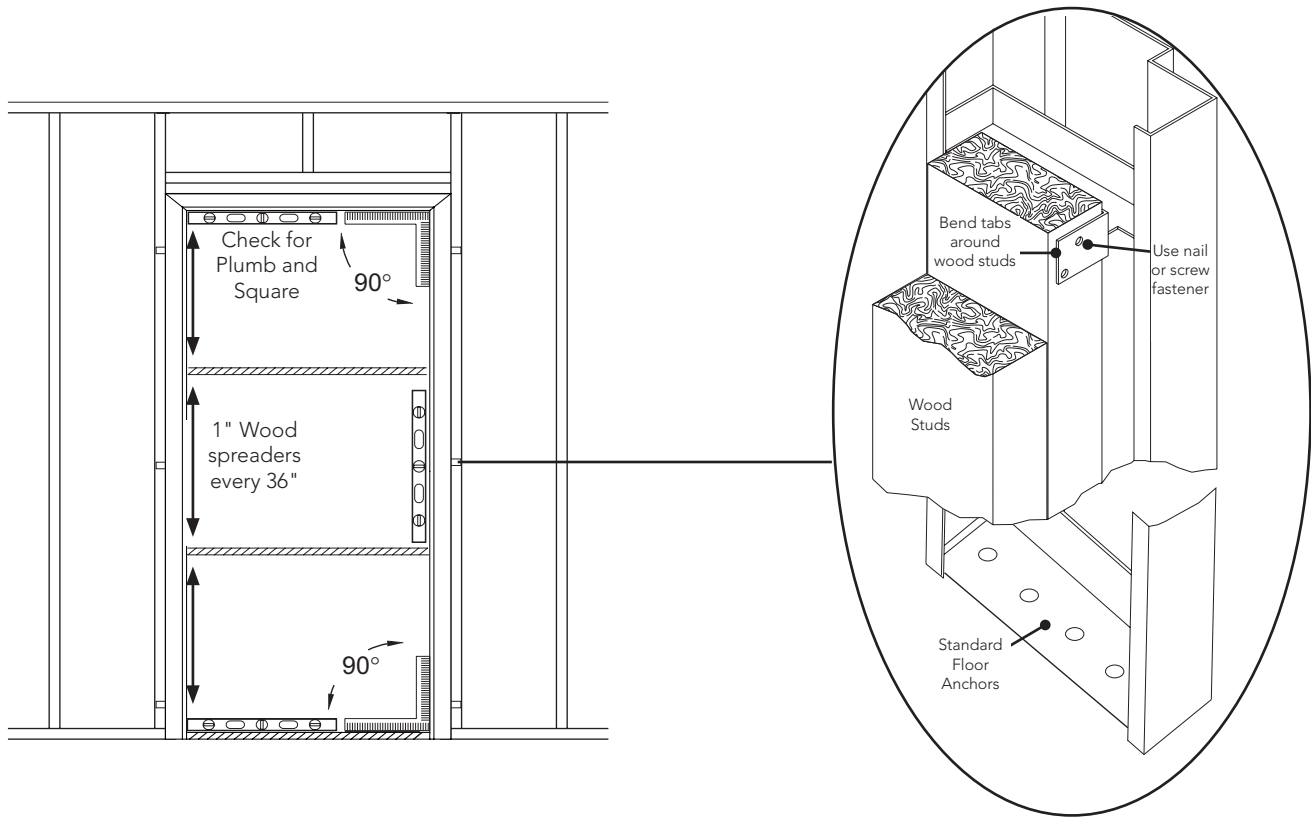

Step 1-
Place frame into stud rough opening.

Step 2-
Bend the flexible anchor tabs around the wood stud at the frame hinge location heights (see illustration) and fasten with suitable fastener (nail or screw).

Step 3-
Set 1" thick wood spreaders into opening as illustrated.

Step 4-
Using a level and a carpenter square, level and square the frame. Shim if necessary.

Step 5-
Fasten sides to floor using the standard floor anchors.

Step 6-
Secure wood stud anchors to stud from the top down one side of the frame.

Check for plumb and square and then continue fastening anchors on the other side of the frame.

Step 7-
Remove wood spreaders.

4

PREPARE FOR DRYWALL/WALL BOARD



DO NOT INSTALL Drywall/Wall Board until you are certain the frame is plumb and square.

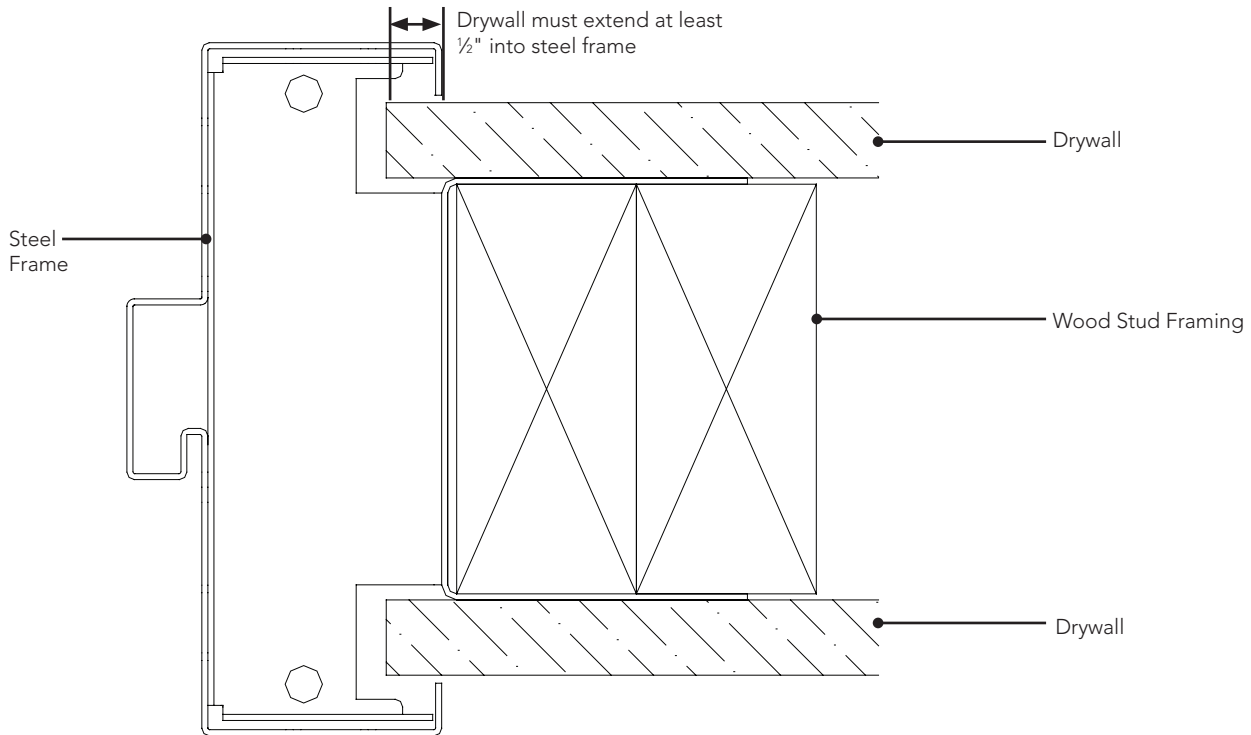

Note: Drywall must extend at least 1/2" into frame for Fire Rated Installation.

Step 1-

Maintain necessary clearance between frame returns and wood stud for inserting drywall/wall board.

Step 2-

Using drywall screws, install the drywall/wall board.



Contact your local recycling waste management center for waste disposal in your area. Always check local waste requirements and carefully dispose of waste in accordance with Federal and other regulations.

Version 1.5 · 01.14.2022 · © 2022 ProVia · P-MK-61050