



INSTRUCTIONS FOR ADDING SIGNET SDL GRIDS TO 420 AND 420DS MODELS

Tools & Materials You Will Need:

- | | |
|--------------------------------------|---------------------------------------|
| • Magnetic Phillips Head Screwdriver | • Power Screwdriver with Phillips Bit |
| • Clear Silicone Caulk | • Sawhorses |
| • Drywall Screw | • Rubber Mallet |

Replacement Trim Package Contents:

- | | |
|-------------------|---|
| Screw Plugs (x12) | SDL replacement glass with attached grids |
|-------------------|---|

REMEMBER: ALWAYS USE THE APPROPRIATE PERSONAL PROTECTIVE EQUIPMENT.



Step 1 Remove door slab from hinges.



Warning! You cannot install new SDLs on door while door is in upright position. The tape is one-sided and will not keep trim and glass from falling out. Door must be positioned onto a flat surface on top of sawhorses.



Due to size and weight of door glass unit, it may be necessary to have two people for these procedures.



Step 2 Lay slab horizontal on sawhorses.

Note:

Rest glass in middle of sawhorse to avoid hitting dental shelf.

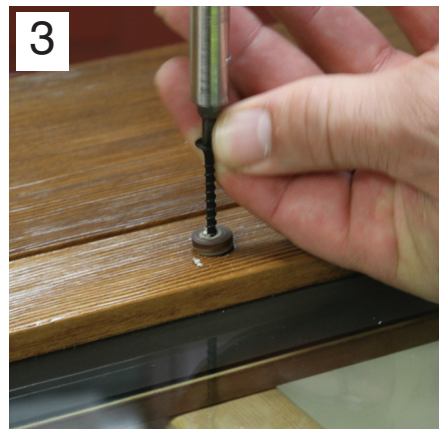

Step 3 Set power screwdriver on forward and let drywall screw drive/bite into plug bringing the plug up from the trim screw boss. Discard old plugs.



WARNING: Do not use a flat head screw driver or any other object to salvage plugs. Doing so could result in damage to the trim.



Step 4 Remove trim screws and trim.

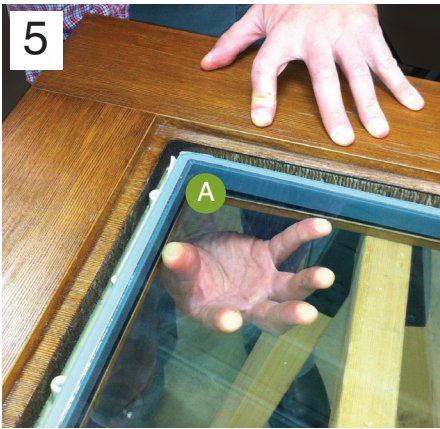

Step 5 Push firmly from corner "A" to break seal and remove glass.



Step 6 Inspect glass side seal tape. If damaged, replace tape. If caulking is present instead of tape, remove and replace with new caulking.

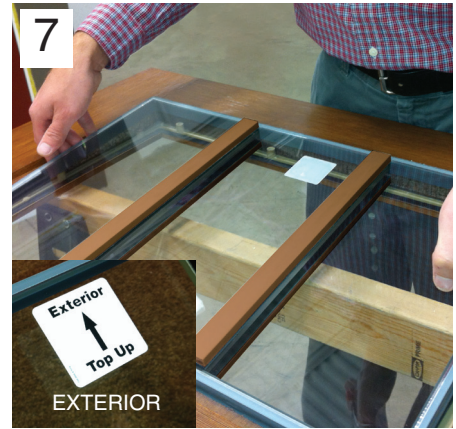

Step 7 Insert new SDL glass with the sticker side out with the arrow pointing towards the top of the door.



Step 8 Make sure interior and exterior trim are aligned with each other, then insert trim into door slab.
Use a magnetic tip screw driver and make sure long screw bites into the exterior trim screw boss.

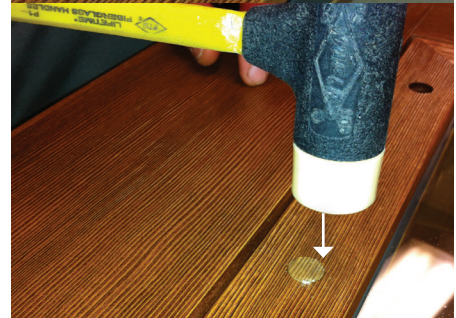

Step 9 Using a rubber mallet, re-plug holes with new supplied plugs, but first add a small dab of caulk before inserting each new plug.



WARNING:
Do not over tighten screws. Over tightening can cause seal leakage and / or damage to the window trim.



Step 10
Re-hang door on hinges.
Double check that hardware fits and latches properly.

Note:
Be sure to align grain of plugs to aesthetically match the woodgrain.