



SINGLE REPLACEMENT DOOR INSTALLATION INSTRUCTIONS

Tools & Materials You Will Need:

• Measuring Tape	• (1) box 2½" - 3" Exterior Decking Screws	• (1) Box Wood Shims
• Pencil	• Hammer & Chisel	• Drill & Drill bits
• Utility Knife	• Level	• Stiff Putty Knife
• Hacksaw or Reciprocating Saw	• Caulking Gun & High-Performance Premium Caulking	• Carpenter's Square

Materials Provided:

• (1) Lockset Adjustable Strike Plate	• (2) Closed-Cell Corner Weather-stripping Pads	• (1) Dust Box
• (4) #8 x 2½" Strike Plate Screws	• (4) #10 x 2½" Security Screws for Hinge to Jamb	• (1) Deadbolt Strike Plate
• (11) #8 x 2¼" Galvanized Deck Screws	• (16) #8 x 2" Aluminum Stop Installation Screws	• (1) Lockset Strike Plate

1 UNPACKAGE NEW UNIT

Step 1- Confirm the new ProVia door is the correct size for the existing opening. Use sizing chart and ordering information from bar coded label on shipping box.

Step 2- Unpackage new door. Confirm swing, color, style, and that order was shipped complete. Inspect for any damage. Double check size of new unit by measuring.

For sizing information please scan the QR code below.



NOTE: If new replacement threshold does not cover all of original sill area, a threshold extension is recommended. See diagram for available applications.

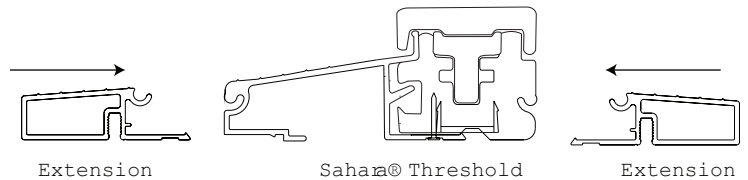

2 PREPARE THE EXISTING OPENING

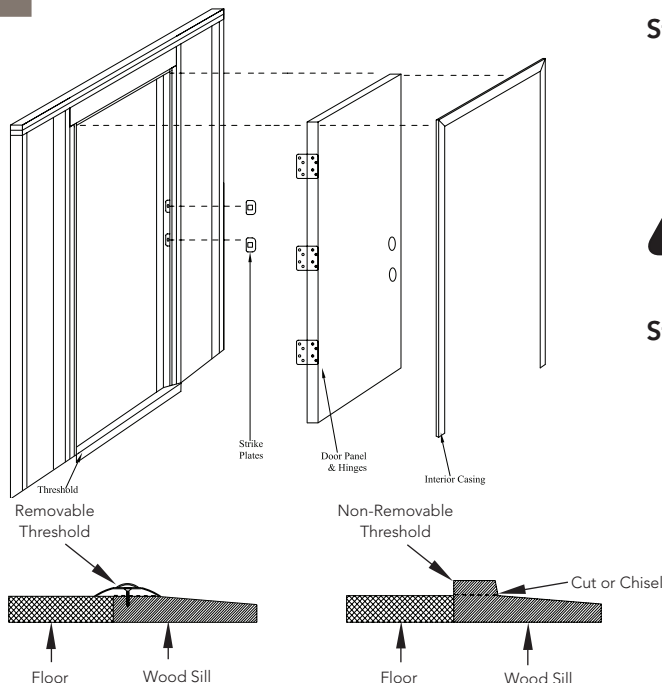

Step 1- Remove existing door slab, hinges and strike plates. Leave old weather-strip in place. For inswing doors, remove interior casing also.



Existing wood jamb must remain in place for new Steel L-Frame to mount to.

Step 2- Prepare existing threshold:

For removable thresholds, remove fastener and it should lift out freely.

For non-removable thresholds, it must be cut down even with the sill. Use an oscillating multi tool or reciprocating saw and chisel.

3 INSTALL REPLACEMENT UNIT

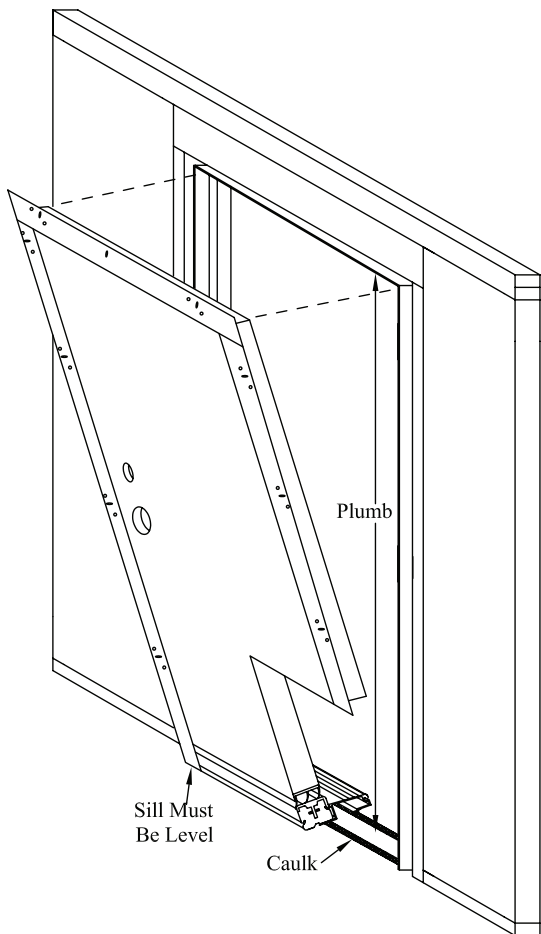

Step 1- Dry fit unit to confirm fit. If sill is not level, adjust with shims between existing sill and new threshold. Jamb must sit directly on top of shims.

Step 2- Apply two generous beads ($\frac{3}{8}$ ") of premium caulking compound on sill, in a STRAIGHT LINE, as in illustration.

Step 3- Set new door unit into opening and center on existing wood jamb.

Step 4- Install four #8 x 2 ¼" Galvanized Deck Screws in slotted holes on face of Steel L-Frame, two at the top and two at the bottom. *Note, if flange is ripped down, new slotted holes may need to be field drilled.*

Step 5- Remove shipping bracket. Open door to check plane. Close door again to check margins. Margins should be approximately $\frac{1}{8}$ " on all sides.

Step 6- Install four #10 x 2 ½" installation screws in countersunk holes of Steel L-frame, two in each side frame at the top and bottom. **OVER-TIGHTENING SCREWS** will cause frame to roll and create margin issues.



NOTE: Avoid rolling the frame when making adjustments.

Step 7- Check plane and margins. For help with adjustments, see TROUBLESHOOTING.

Step 8- After correcting any plane and margin issues, install remaining screws in Steel L-Frame. Continue to monitor the plane and margins.

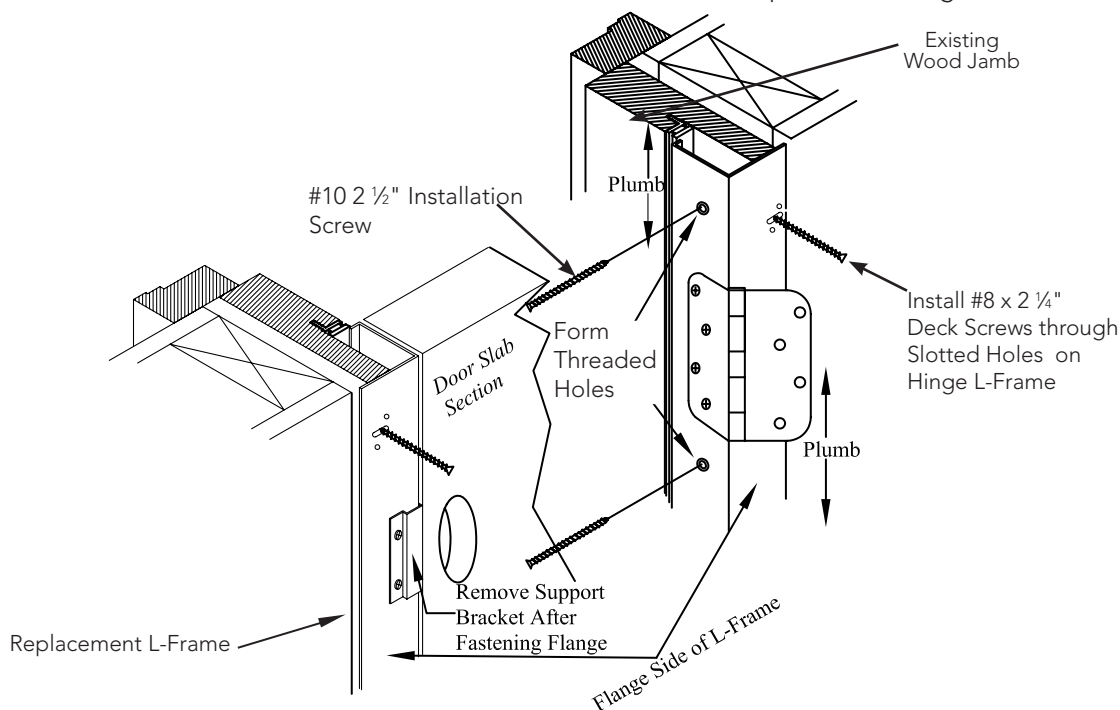

4 INSTALL ALUMINUM STOP & WEATHER STRIP

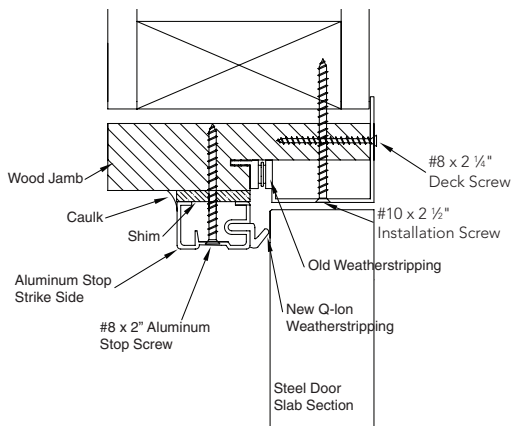
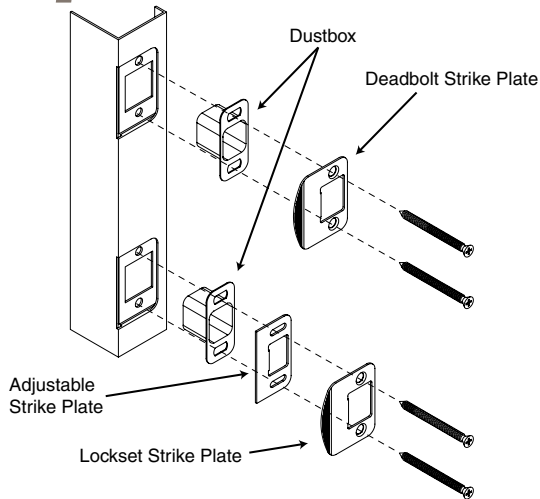

INSWING

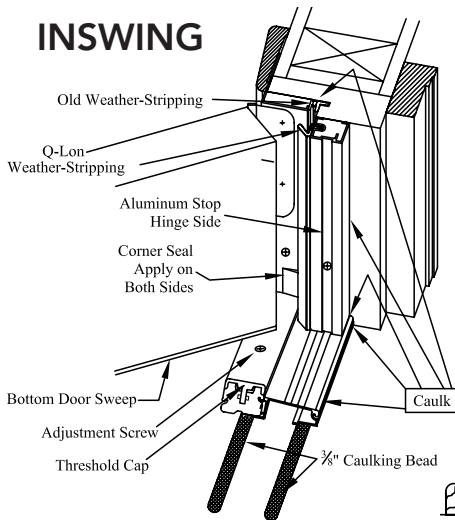

- Step 1-** Install Strike Plates. See illustration. **DO NOT OVERTIGHTEN SCREWS.**
- Step 2-** Install locket and deadbolt.
- Step 3-** Adjust lockset strike plate until door slab is even with face of Steel L-Frame when closed.
- Step 4-** Measure and cut aluminum header stop with hacksaw or chopsaw.



Remove Q-Lon Weather-Stripping before cutting stop to length with hacksaw or chopsaw.

- Step 5-** Install aluminum header stop on wood jamb using #8 x 2" screws provided. The weather-stripping should be compressed against door slab, approximately 3/8" to 1/2" space between door slab and edge of aluminum stop.



NOTE: Door must be closed when installing stops. Weather-stripping should make firm contact with door panel.

- Step 6-** Measure and cut aluminum side stops with hacksaw or chopsaw.
- Step 7-** Install aluminum side stops on wood jamb using #8 x 2" screws provided. Match spacing to door slab with the header stop.
- Step 8-** Install closed-cell corner seals.
- Step 9-** If necessary, adjust threshold cap even with the bottom of the door sweep.
- Step 10-** Caulk around aluminum stops at all corners and edges. See illustration
- Step 11-** Re-install interior casing.

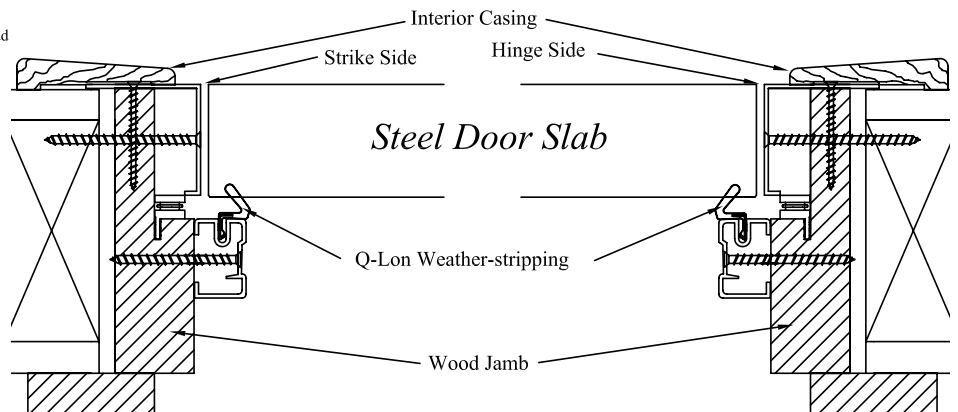

TROUBLESHOOTING

PROBLEM	SOLUTION
Strike margin is too small (panel hits frame on strike side):	<p>loosen 2 ¼" galvanized deck screws then pull hinge side installation screws toward wood frame. Retighten deck screws.</p> <p>and/or</p> <p>loosen installation screw then pull strike side installation screws toward wood frame.</p>
Header margin is too small on strike side:	loosen strike side 2 ¼" galvanized deck screws and installation screws and shim underneath steel L-frame on strike side to raise frame away from door panel.
Header margin is too large on strike side:	loosen hinge side 2 ¼" galvanized deck screws and installation screws and shim underneath steel L-frame on hinge side to raise door panel in frame.



Homes built before 1978 may contain lead paint. All replacement installations must comply with the U.S. EPA's Lead-Based Paint Renovation, Repair, and Painting Program (RRP Rule). Read more about the RRP Rule and lead-safe work practices, on the U.S. EPA's website at: www.epa.gov/lead



Contact your local recycling waste management center for waste disposal in your area. Always check local waste requirements and carefully dispose of waste in accordance with Federal and other regulations.

Version 4.7 - 03.05.2019 - © 2019 ProVia - P-MK-61105